

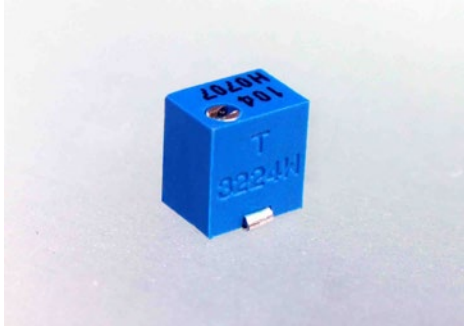

PO 3224jxxxx, PO 3224wxxxx

MICROS



Features

- Surface Mount
- 4mm Square
- Multi-turns / Cermet
- Industrial / Sealed

Trimmer 4mm Square SMD Trimming Potentiometer

Electrical Characteristics

Standard Resistance Range
10 to 2 megohms
(see standard resistance table)
Resistance Tolerance
±10% std.
(tighter tolerance is available)
Absolute Minimum Resistance
1% or 2 ohms max.
(whichever is greater)
Contact Resistance Variation
3% or 3 ohms max.
(whichever is greater)
Resolution
Essentially Infinite
Insulation Resistance
500 vdc
1,000 megohms min.
Dielectric Strength
101.3 KPa 600 Vac
8.5 KPa 250 Vac
Effective Travel
11 turns nom.

3224-W

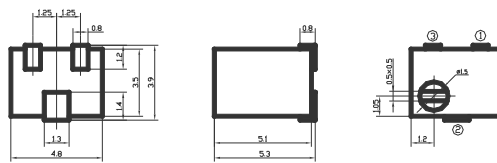

RECOMMENDED PCB LAYOUT

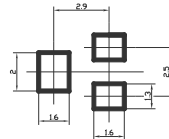

Environmental Characteristics

Power Rating (200 volts max.)
0.25 watt (70°C), 0 watt (125°C)
Temperature Range
-55°C to +125°C
Temperature Coefficient
±100ppm/°C
Vibration
98 m/s²
(1% Δ TR; 1% Δ VR)
Shock
490 m/s²
(1% Δ TR; 1% Δ VR)
Load Life
1,000 hours 0.25 watt @ 70°C
(3% Δ TR; 3% or 3 ohm,
whichever is greater, CRV)
Rotational Life
200 cycles
(3% Δ TR; 3% or 3 ohm,
whichever is greater, CRV)
Thermal Shock
5 cycles
(2% Δ TR; 1% Δ VR)

3224-J

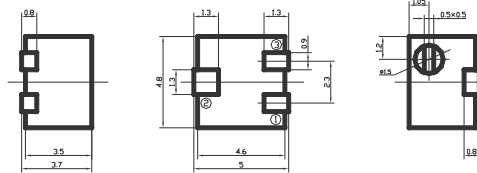

RECOMMENDED PCB LAYOUT

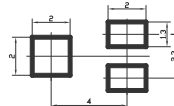

Standard Resistance Table

| Resistance (Ohms) | Resistance Code |
|-------------------|-----------------|
| 10 | 100 |
| 20 | 200 |
| 50 | 500 |
| 100 | 101 |
| 200 | 201 |
| 500 | 501 |
| 1,000 | 102 |
| 2,000 | 202 |
| 5,000 | 502 |
| 10,000 | 103 |
| 20,000 | 203 |
| 25,000 | 253 |
| 50,000 | 503 |
| 100,000 | 104 |
| 200,000 | 204 |
| 250,000 | 254 |
| 500,000 | 504 |
| 1,000,000 | 105 |
| 2,000,000 | 205 |

* Special resistance is available

TCR of shaded areas +/-250ppm/°C

Detail Specification: Q/RYS15-2003

Physical Characteristics

Torque
25 mN • m max.
Mechanical Stops
Wiper idles
Wiper
Set at 50% nominal

