

# SURFACE & THRU HOLE MOUNT COMPACT CONTACTS

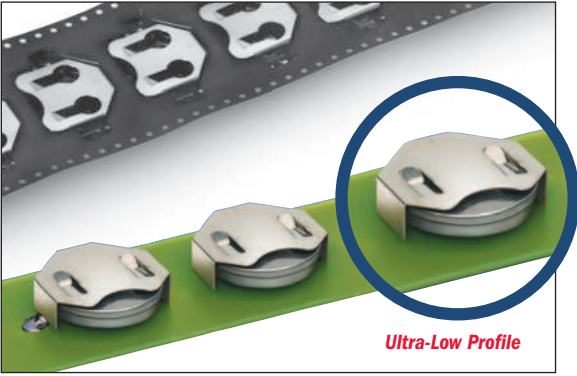

**AVAILABLE ON TAPE AND REEL**

Economical and reliable retainer contacts are designed for quick and easy battery installation and replacement. Perfect for memory back-up applications. Surface and Thru Hole mount retainer contacts are available for 6.8mm to 24mm lithium coin cell batteries.

- Low profile for densely packed PCBs
- Retains cell securely, withstands shock & vibrations
- Reliable dual spring contacts assure low contact resistance
- Polarity clearly marked (+)
- Stable thru mount legs for increased strength
- Balanced & lightweight for reliable pick-up & placement
- Compatible with vacuum and mechanical pick & place assembly systems
- "Flow-Hole" SMT solder tail design for increased joint strength
- Viewable solder tails assures reliable joint inspection
- All conductive polystyrene carrier tape meets ANSI/EIA- 481 standard

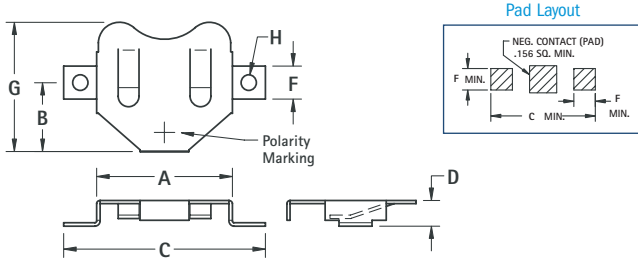

**DWG. 1 - SURFACE MOUNT (SMT) MATERIAL:** .010 (.25) thick Phosphor Bronze, Tin Nickel Plate

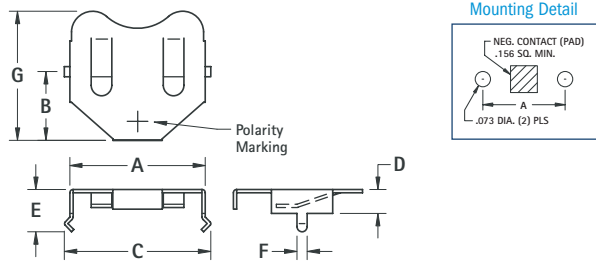

**DWG. 2 - THRU HOLE MOUNT (THM) MATERIAL:** .010 (.25) thick Phosphor Bronze, Tin Nickel Plate

CAT. NO.	ON TAPE & REEL	DWG. NO.	MTG. TYPE	A	B	C	D	E	F	G	H DIA.	CELL DIA.	BATTERY REFERENCE	TAPE & REEL SPEC'S
2996	2996TR	1	SMT	.520 (13.2)	.265 (6.7)	.700 (17.8)	.235 (6.0)	—	.125 (3.2)	.500 (12.7)	NO HOLE	11.6mm	SR44, LR44, 357, MS76, PX76A, G-13, 303, V313	32mm wide; 16mm pitch; 13 inch reel (600 pieces per reel)
3000	3000TR	1	SMT	.520 (13.2)	.265 (6.7)	.745 (18.9)	.125 (3.2)	—	.125 (3.2)	.500 (12.7)	.047 (1.2)	12mm	BR1216, CR1216, BR1220, CL1220, CR1220, BR1225	32mm wide; 16mm pitch; 13 inch reel (1000 pieces per reel)
3012	3012TR	1	SMT	.664 (16.9)	.344 (8.7)	.914 (23.2)	.156 (4.0)	—	.125 (3.2)	.594 (15.1)	.047 (1.2)	16mm	BR1616, CR1612, CR1616, CR1620, CR1632	44mm wide; 24mm pitch; 13 inch reel (600 pieces per reel)
3002	3002TR	1	SMT	.831 (21.1)	.416 (10.6)	1.210 (30.7)	.156 (4.0)	—	.200 (5.1)	.782 (19.9)	.093 (2.4)	20mm	BR2016, CR2016, DL2016, BR2020, CL2020, BR2025, CR2025, DL2025, DR2032, CR2032, DL2032	44mm wide; 24mm pitch; 13 inch reel (500 pieces per reel)
3004	3004TR	1	SMT	.939 (23.9)	.475 (12.1)	1.339 (34.0)	.145 (3.7)	—	.200 (5.1)	.939 (23.9)	.093 (2.4)	23mm	BR2320, CL2330, CR2320, BR2325, CR2325, DL2325	56mm wide; 32mm pitch; 13 inch reel (400 pieces per reel)
3010	3010TR	1	SMT	.939 (23.9)	.475 (12.1)	1.339 (34.0)	.240 (6.1)	—	.200 (5.1)	.819 (20.8)	.093 (2.4)	23mm	CR2354, DL2354	56mm wide; 32mm pitch; 13 inch reel (200 pieces per reel)
3006	3006TR	1	SMT	1.000 (25.4)	.506 (12.9)	1.400 (35.6)	.156 (4.0)	—	.200 (5.1)	.918 (23.3)	.093 (2.4)	24mm	CR2430, DL2430	56mm wide; 32mm pitch; 13 inch reel (400 pieces per reel)
3007	—	2	THM	1.000 (25.4)	.506 (12.9)	1.065 (27.1)	.145 (3.7)	—	.265 (6.7)	.918 (23.3)	—	24mm	—	—
3008	3008TR	1	SMT	1.000 (25.4)	.506 (12.9)	1.400 (35.6)	.230 (5.8)	—	.200 (5.1)	.890 (22.6)	.093 (2.4)	24mm	CR2450, DL2450	56mm wide; 32mm pitch; 13 inch reel (200 pieces per reel)
3009	—	2	THM	1.000 (25.4)	.506 (12.9)	1.059 (26.9)	.230 (5.8)	—	.350 (8.9)	.890 (22.6)	—	24mm	—	—

## For 6.8mm BUTTON CELLS

**AVAILABLE ON TAPE AND REEL**

**MATERIAL:** .010 (.25) thick Phosphor Bronze, Tin Nickel Plate

**Tape & Reel Spec's:** 24mm wide; 12mm pitch; 13 inch reel (1250 pieces per reel)

**CAT. NO. 2998** (Bulk)

**CAT. NO. 2998TR** (Tape and Reel)

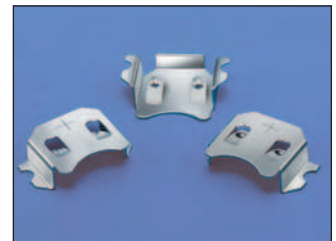
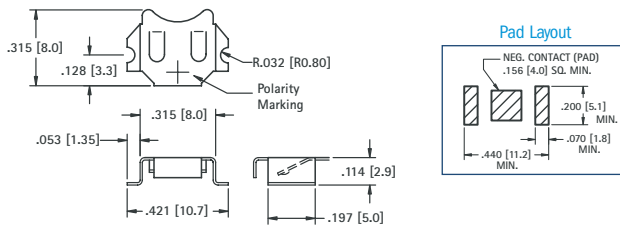

For use with Batteries MC621, V364 and SC621

# NEGATIVE BATTERY CONTACTS

- Economical
- Space saving
- Ideal for self-contained battery compartments
- Contact us for modifications and custom design

## THRU HOLE MOUNT

• Snap-In

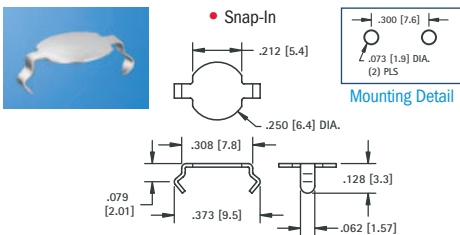

**CAT. NO. 2990**

**MATERIAL:** .008 (.20) thick Phosphor Bronze, Tin Nickel Plate

## SURFACE MOUNT



**MATERIAL:** .008 (.20) thick Brass, Tin Nickel Plate

**Tape & Reel Spec's:** 16mm wide; 8mm pitch; 7 inch reel (1500 pieces per reel)

**CAT. NO. 2991** (Bulk)

**CAT. NO. 2991TR** (Tape and Reel)

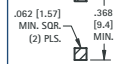
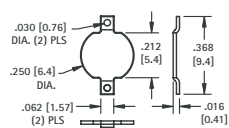

## THRU HOLE MOUNT

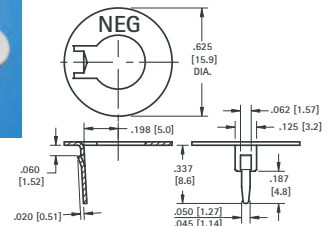

**CAT. NO. 105-3**

**MATERIAL:** .020 (.51) thick Spring Steel, Tin Nickel Plate