

15

14

13

12

11

10

9

8

7

6

5

4

3

2

1

REV	DESCRIPTION	DATE
A/0	原始版本	E
A/1	修订版本	

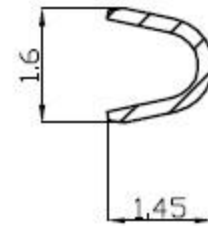
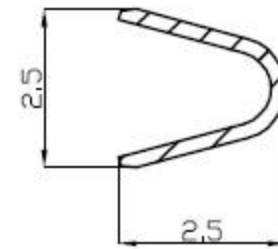
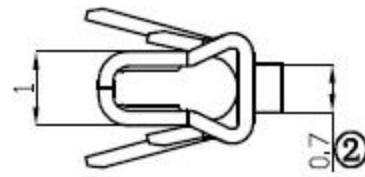
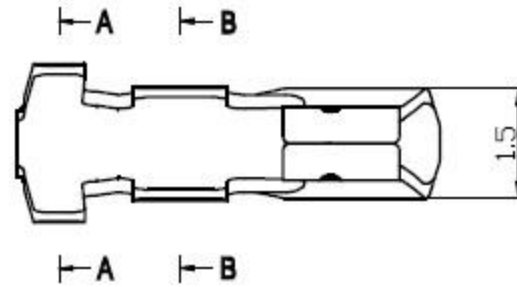

A-A

B-B

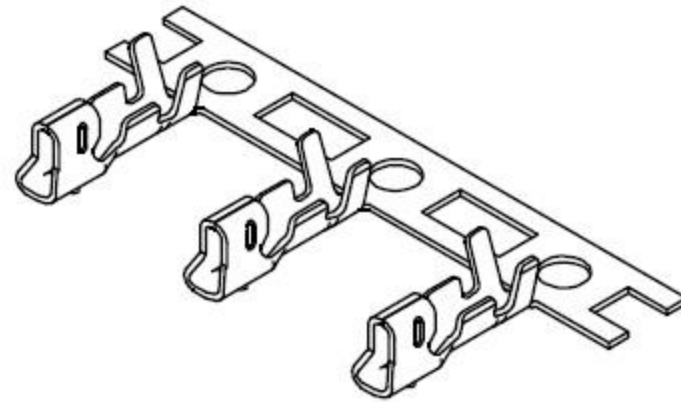
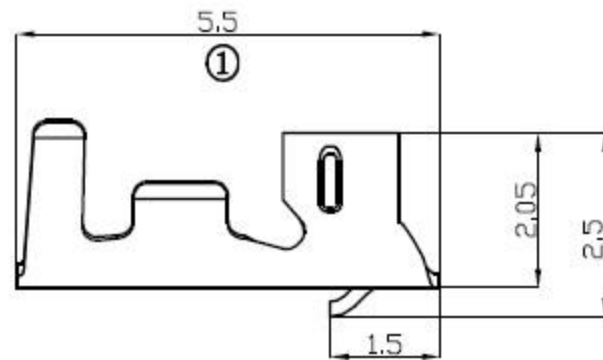

Main Specifications

线数 (poles): 2 to 20P

额定电流 (Current rating): 2.0A AC, DC

额定电压 (Voltage rating): 100V AC, DC

温度范围 (Temperature range): -25°C to +85°C

接触电阻 (Contact resistance): $\leq 10\text{m}\Omega$

绝缘电阻 (Insulation resistance): $\geq 1000\text{M}\Omega$

耐电压 (Withstand voltage): 800V AC/minute

适用线规 (Applicable wire): AWG #32 to #24

适用基板厚度 (Applicable PC board thickness): 0.8 to 1.6mm

1		Phos Bronze tin	T21	10000PCS/RoII (1盘)
---	--	-----------------	-----	--------------------

X.° ±3° X.X° ±0.5°									
>0-3	>3-18	>18-50	>50-120						
±0.12	±0.15	±0.3	±0.5	MM Only	—	METRIC	A4		
				批准	材料	图号	Part No		
				见图解	品名				

15

14

13

12

11

10

9

8

7

6

5

4

3

2

1