

REV.	ECON. NO.	REVISE. NO.	REVISER	APPD.
版本	CON. 编号	次数	修订者	核准
R1	DRAWING			

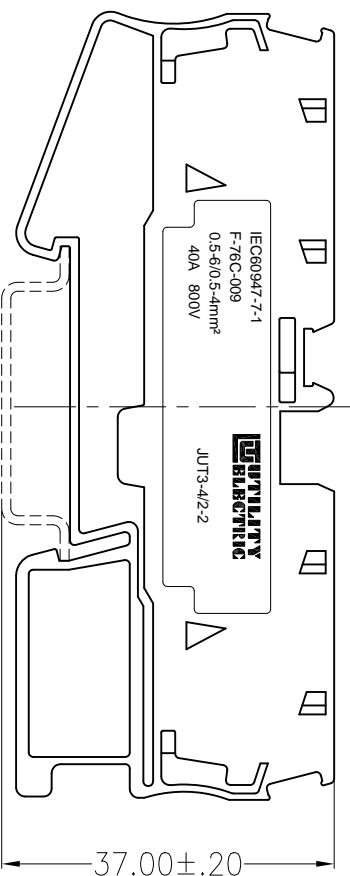
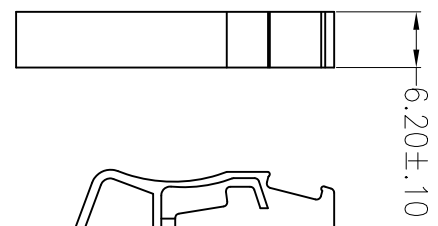
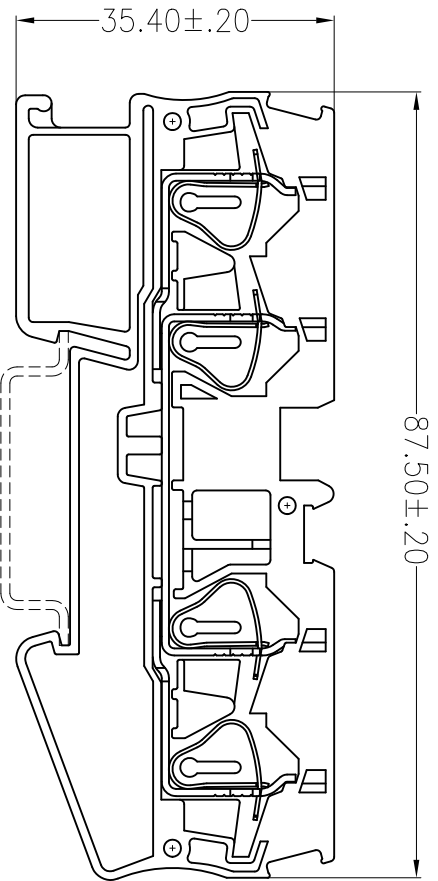

### Technical Data

**Material:**

- Body: PA66 UL94 V-0.
- Conductor: Copper, Tin Plated.
- Spring: SUS 301.

**Electrical:**

- Voltage rating/Current ratings: IEC 800V/32 A; UL 600V/30 A

Contact resistance: 20 mΩ Max.

Insulation resistance: 500V, 500 MΩ Min.

Withstanding Voltage: AC 3000 V, 1 minute.

**Mechanical:**

Connection Capacity: 24-12AWG.

Stripping Length: 12mm.

Operating temperature: -45° C to +105° C.

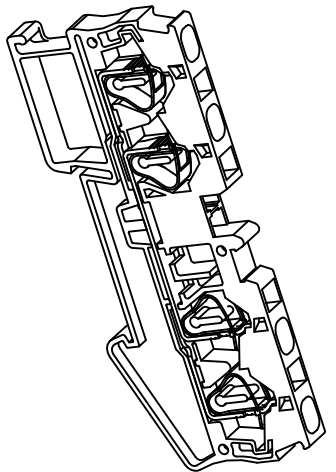

**ZHEJIANG UTILITY ELECTRICAL CO., LTD**  
**浙江尤提乐电气有限公司**

>120	±0.50			TYPE NO.	JUT3-4/2-2	TITLE:	名称:	Customer Drawing
>30~120	±0.30			APPD.	核准:	DWG. NO.:	图号:	C-DW0400-0
>6~30	±0.20			CHKD.	审核:	SCALE:	比例:	FULL
0~6	±0.10	ANGLE	±1°	DR.	设计:	UNIT:	单位:	mm[inch]
MAT'L.		材料:		Jeammy.ling		PAGE:	页码:	1/1
						REV.:	版本:	R1