		/012	GY-MSK-81043
SPECIFICATION 567		8 2 9	2012 3 10 4 10 1 1 of 2
;;<= : 拨动开关 ;;B# MSK23D18G2/102			
DRAW CD		APPD.GH	
1. RATING(LDM): DC 12V 100mA			
2. ELECTRICAL CHARACTERISTICS(NOP56):			
ITEM QR	TEST CONDITIONS STU!		PERFORMANCE 56
2.1	CONTACT RESISTANCE VW)X	MEASURED AT SMALL CURRENT(100mA OR LESS) YZ[]\ (100mA)]^ST .	100m_ MAX. 100`a]^ .
2.2	INSULATION RESISTANCE bc)X	APPLY A VOLTAGE OF 100V DC FOR 1 MIN. TO FOLLOWING PORTIONS AFTER WHICH MEASUREMENT SHALL BE MADE. 1) BETWEEN BODY AND CONDUCTOR. 2) BETWEEN CONDUCTORS NOT TO BE CONTACT. de 100V DC)f l gh , i]^V W jkST : 1) VW l *mn ; 2) op q rst mn .	50M_ MIN. 50ua]v .
2.3	DIELECTRIC STRENGTH w)f	AC 250V (50-60Hz) FOR 1 MIN TRIP CURRENT: 0.5mA 1) BETWEEN TERMINALS. 2) BETWEEN INDIVIDUAL TERMINALS AND FRAME. de AC 250V(50-60Hz))f , l g h xy) \z 0.5mA, i] ^VWj k ST : 1) st { mn ; 2) st r }~mn .	WITHOUT DAMAGE TO PARTS ARCING OR BREAKDOWN ETC. +bc !"#\$.
3. MECHANICAL CHARACTERISTICS(%& OP56)			
ITEM QR	TEST CONDITIONS STU!		PERFORMANCE 56
3.1	OPERATING FORCE ' ()	侧向推动	推动力度:200gf ± 50gf
3.2	TERMINAL STRENGTH l* + y	A STATIC LOAD OF (500gf) SHALL BE APPLIED TO THE TIP OF THE TERMINAL FOR 1 MIN IN ANY DIRECTION. Y ,-. / j 012 l 3 v (500gf) yST , 4 nz l gh .	ELECTRICAL CHARACTERISTICS SHALL BE SATISFIED WITHOUT DAMAGE OR EXCESSIVE LOOSENESS OF ACTUATOR Yl* 5 + 6 @ , 7' "# \$, 89: %& ,) ; OP .
3.3	STANDARD ATMOSPHEIC CONDITIONS ST <= >?	UNLESS OTHERWISE SPECIFIED. THE STANDARD RANGE OF ATMOSPHERIC CONDITIONS FOR MAKING MEASUREMENTS AND TESTS ARE AS FOLLOWS: 1) AMBIENT TEMPERATURE: 5@ TO 35@ 2) RELATIVE HUMIDITY: 45% TO 85% 3) AIR PRESSURE: 80Kpa~106Kpa. Y + A D 1BC ^ ST D y ,E y ,Nf F ^ : 1) D yz 5@ ~35@ ; 2) E yz 45%~85%; 3) N fz 80Kpa~106Kpa.	

		!"#	GY-MSK-81043
		/012	2012 3 104 10 1
SPECIFICATION 567		8 2 9	2 of 2
3.4	PRACTICAL TEMPERATURE RANGE GHD y LM	-10@ ~+50@ . Y -10@ ~+50@D y N GH .	
4. DURABILITY(w 0 0):			
ITEM QR		TEST CONDITIONS STU!	PERFORMANCE 56
4.1	LIFE TEST PQ T R	WITHOUTLOAD: AN ACTUATOR SHALL BE SUBJECT TO 7,000 - 10,000 CYCLES AT A SPEED OF 30 CYCLES FOR 1 MIN. STU : V(W] X gh 30 Y 1 Z [(7,000-10,000 Y m S TU ST .	1) CONTACT RESISTANCE SHALL BE 500m_ MAX. 2) MECHANICAL AND ELECTRICAL CHARACTERISTICS SHALL BE SATISFIED. 1) VW)X] P ^ _ : 500m_ 2) `a 8 9 :%& ,) N OP .
4.2	HEAT TEST w b T R	THE SWITCH SHALL BE STORED AT A TEMPERATURE OF 85±2@ FOR 96 HOURS. AND THEN IT SHALL BE SUBJECTED TO THE CONTROLLED RECOVERY CONDITIONS FOR 1 HOUR AFTER WHICH MEASUREMENT SHALL BE MADE. cd Y D y 85±2@5 96 [4e ,fc d g\$h D5 1 [4e SD .	THERE SHALL BE NO DAMAGE ON APPEARANCE. MECHANICAL AND ELECTRICAL CHARACTERISTICS SHALL BE SATISFIED. } iS#\$, 89 : %& ,) N OP .
4.3	COLD TEST w j T R	THE SWITCH SHALL BE STORED AT A TEMPERATURE OF -25±3@ FOR 96 HOURS. AND THEN IT SHALL BE SUBJECTED TO THE CONTROLLED RECOVERY CONDITIONS FOR 1 HOUR AFTER WHICH MEASUREMENT SHALL BE MADE. cd Y D y -25±3@5 96 [4e ,fc d g\$h D5 1 [4e SD .	THERE SHALL BE NO DEFORMATION OR CRACKS IN MOLDED PART. } iS#\$, 89 : %& ,) N OP .
4.4	HUMIDITY TEST kE T R	THE SWITCH SHALL BE STORED AT A TEMPERATURE OF 40±2@ AND A HUMIDITY OF 80% TO 85% FOR 96 HOURS. THEN THE SWITCH SHALL BE MAINTAINED AT STANDARD ATMOSPHERIC CONDITIONS FOR 1 HOUR FOR OTHER PROCEDURES BE MADE. cd Y 40±2@ { 1E yz 80~85% m n5 96 [4 e , fop ; c Y g \$mn5 1 [4 e qr SD .	} iS#\$, 89 : %& ,) N OP .
4.5	SOLDERING CONDITIONS st U!	HAND SOLDERING us : 1) DIVICE vw : SOLDER IRON) xy . A. 350@ Max. 3sec Max. B. 270@ Max. 5sec Max. 2) REFLOW SOLDERING \ \ s : ≤ 250 @ 	THERE SHALL BE NO DEFORMATION OR CRACKS IN MOLDED PART. } iS#\$, 89 : %& ,) N OP .

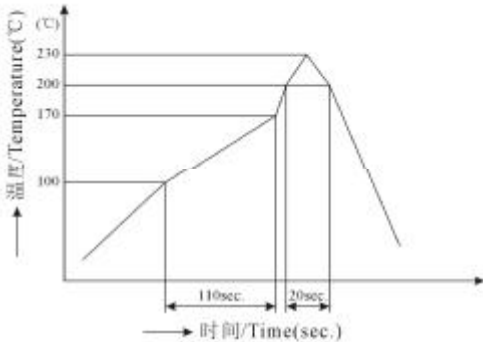
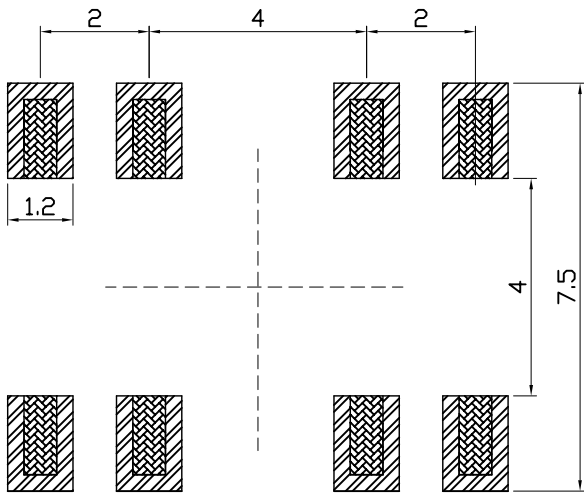
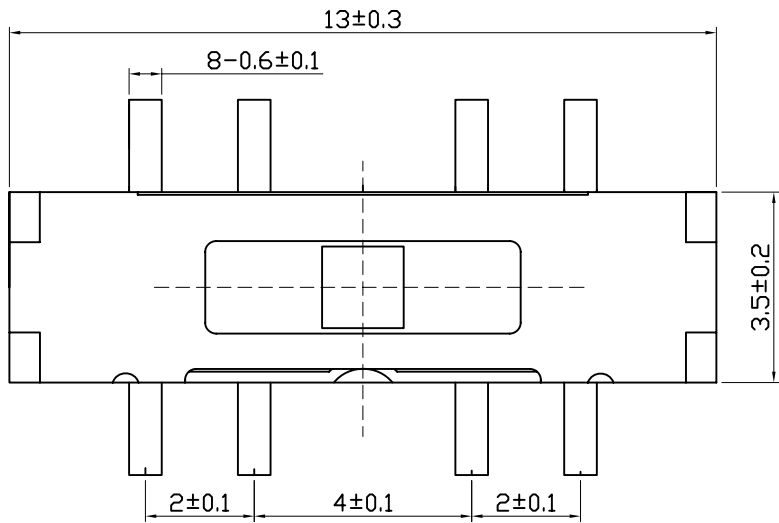
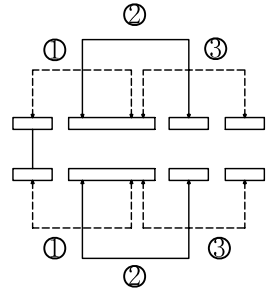
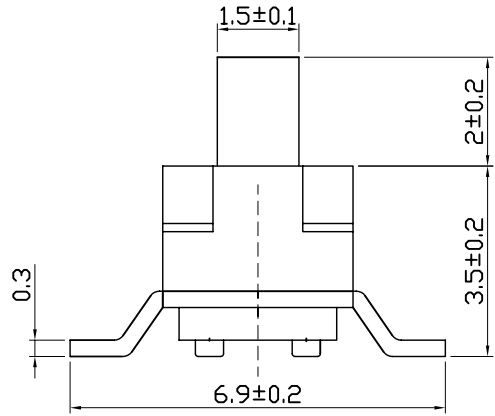
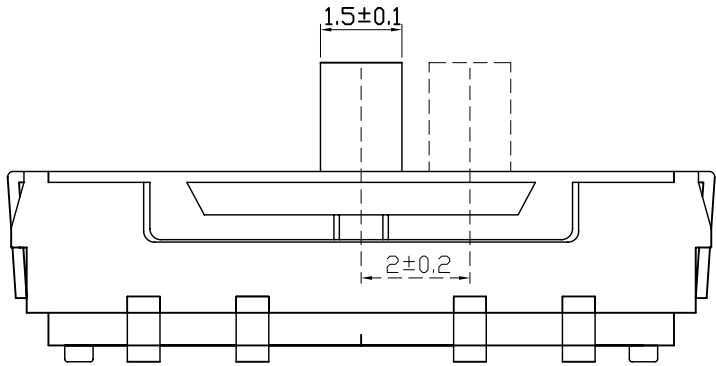

E					TACTRONIC	
D	接触簧片	2	铍青铜	银白色		
C	盖子	1	不锈钢	本色	MSK23D18G2/102	一般公差: ±0.2
B	底座	1	进口增强尼龙 和磷铜	黑色与镀银		
A	推柄	1	进口增强尼龙	黑色		
序号	名称	数量	材料	镀涂颜色	校对:	日期:
						审核:
						日期: